



LAND OF SRI K. MITTER

*M. S. Red*  
DRAWN BY *Surveyor*  
1-6-1960.

NETAJI SUBHAS CHANDRA (BANGDHANI ROAD) BSE ROAD.



*M. S. Red*  
*Surveyor*

Dr. Amarendra Babbar

PLAN OF  
 SCHEME PLOT NO. 23, 24, & 27 NEW PREMISES NO. 364 NETAJI SUBHAS CHANDRA BOSE ROAD (FORMERLY NO. 33  
 BANDHANI ROAD) PORTION OF C.S. DAG NOS. 477, <sup>470</sup>/<sub>486</sub> & 470. KHAIAN NOS. 296, 297, 298, 281, 157 AND 56  
 J. L. NO. 32, MAUZA - NAKTALA, PAR GANA - KHASPUR, THANA - TOLLYGUNGE SADAR, DISTRICT - 24 - PAR GANAS.

SCALE 1/320 FT. = 1" INCH.

REFERENCES.

1. C.S. BOUNDARY SHOWN THUS. - - - - -
2. PLOT BOUNDARY SHOWN THUS. - - - - -
3. AREA OF PLOT NO. 23, (PORTION OF C.S. DAG NO. 477) = 5 - 7 - 8.
4. AREA OF PLOT NO. 24, (PORTION OF C.S. DAG NO. <sup>470</sup>/<sub>486</sub>) = 2 - 7 - 10.
5. AREA OF PLOT NO. 24, (PORTION OF C.S. DAG NO. 470) = 2 - 13 - 18.
- TOTAL AREA OF PLOT NO. 24 = 3 - 4 - 28.
6. AREA OF PLOT NO. 27, (PORTION OF C.S. DAG NO. 470) = 4 - 7 - 32.

ALLOTMENT OF PLOTS.

S. NO.	NAME	PLOT NO.	AREA OF PLOT	COLOR
1.	KUMARI NAMITA BAKSI	24	K. CH. SFT. 3 - 4 - 28.	GREEN VERGE.
2.	KUMARI KRISHNA BAKSI	27	K. CH. SFT. 4 - 7 - 32.	YELLOW VERGE.
3.	KUMARI BHARATI BAKSI	23	K. CH. SFT. 5 - 7 - 8.	BLUE VERGE.

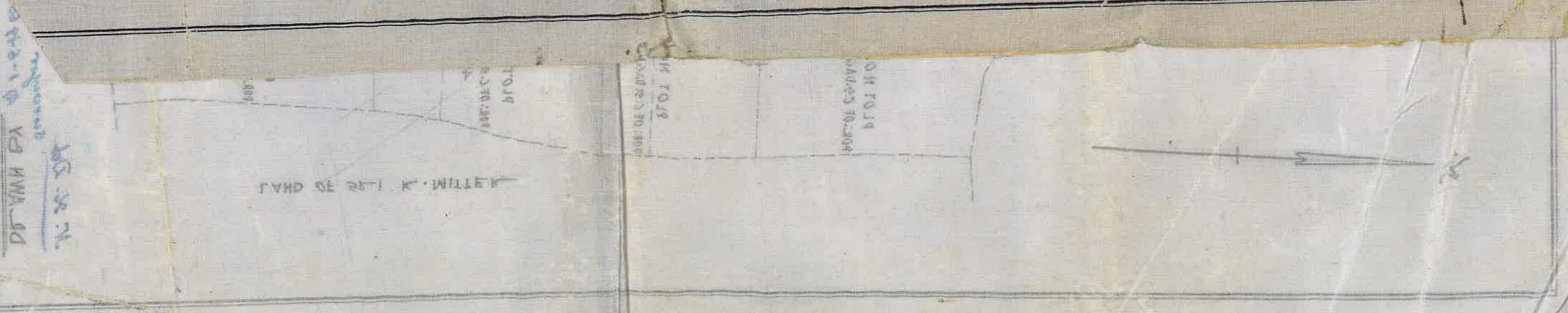

Dated the \_\_\_\_\_ day of \_\_\_\_\_ 1960.

237(66-67)  
of 2804 Ms. Alipore  
25/6/60



MRS. PRATIHA BAKSI.  
A N D  
KUMARI NOLITA BAKSI & OTHERS

Sub Registrar, Alipore,  
Sadar.

25/6/60



Deed of Settlement

Filed in  
Ser. No. I  
Volume No. 99  
Pages 41 to 46  
Serial No. 5341  
for the year 1960

*[Signature]*  
Sub Registrar, Alipore,  
Sadar,  
25/6/60